

**COMPRESSOR**

Displacement (cm <sup>3</sup> )	16.14
Diameter (mm)	31.19
Stroke (mm)	21.13
Net Weight (Kg)	12
Oil type	ISO VG 22 ESTER
Oil charge (cm <sup>3</sup> )	530

**MOTOR**

Approximate Power (CV)	3/8
Voltage/Frequency (V/Hz)	220V 50Hz
Voltage range (V)	187-264
Code	61.557
Type	RSIR
Phase number	1 PH
Locked rotor current (A)	20.1
Main W. resist. at 25°C (Ω)	5.61
Start W. resist. at 25°C (Ω)	22.94

**APPLICATION**

Application	Low back pressure
Refrigerant	R134a
Evaporating (°C)	-35 to -10
Expansion	Capillar
Comp. cooling	Fan cooled
Max. ambient temp. (°C)	43

NOMINAL PERFORMANCE	CYCLE A	CYCLE B
Cooling capacity (kcal/h)	229	315
Input power (W)	300	320
EER (kcal/Wh)	0.76	0.98
COP (W/W)	0.88	1.14
Current (A)	2.13	2.19

**TEST CONDITIONS**

Evaporating temp. (°C)	-25.0	-23.3
Condensing temp. (°C)	55.0	55.0
Liq.t. entering expan. (°C)	55.0	32.0
Ambient t. and return (°C)	32.0	32.0
Tens/Freq (V/Hz)	220V 50Hz	220V 50Hz

**ELECTRICAL COMPONENTS**

Relay	2014 149.	
Pick-Up (A)	7,80	
Drop-Out (A)	6,65	
Protector	MRT40AMK	T0137
Current (A)	9.5	9.5
Time check (seg)	7.5-14	7.5-14
Disc temp. (Open/Close) (°C)	105.0 / 61.0	110.0 / 61.0

**DIMENSIONS AND ELECTRICAL DIAGRAM**

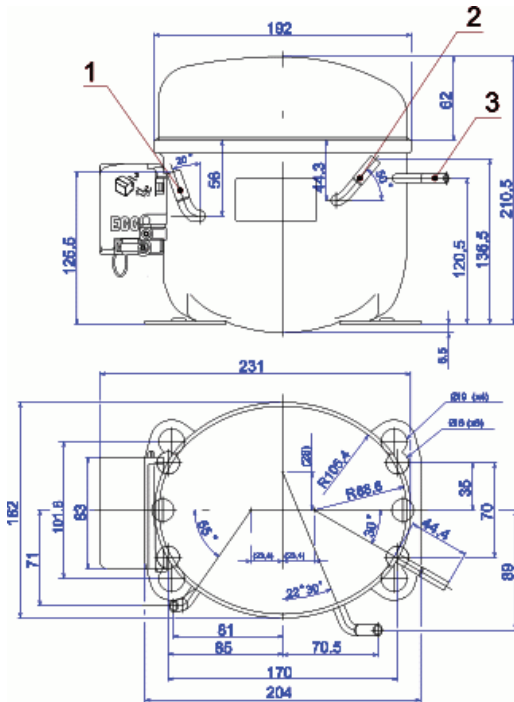

DESIGNATION	INTERNAL DIAM. (MM)
1 Suction/Service	8,1
2 Service/Suction	8,1
3 Discharge	6,55

**RSIR**

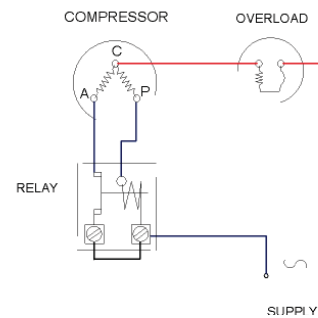

**TEST CONDITIONS**

Voltage/frequency	220V 50Hz
Ambient t. and return	32 °C
Liq.t. entering expan.	Subcooling at 32 °C

**MASS FLOW**

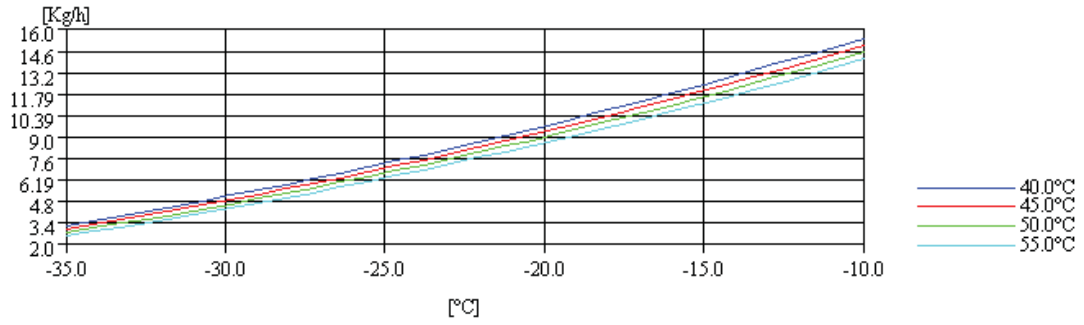

**INTENSITY**

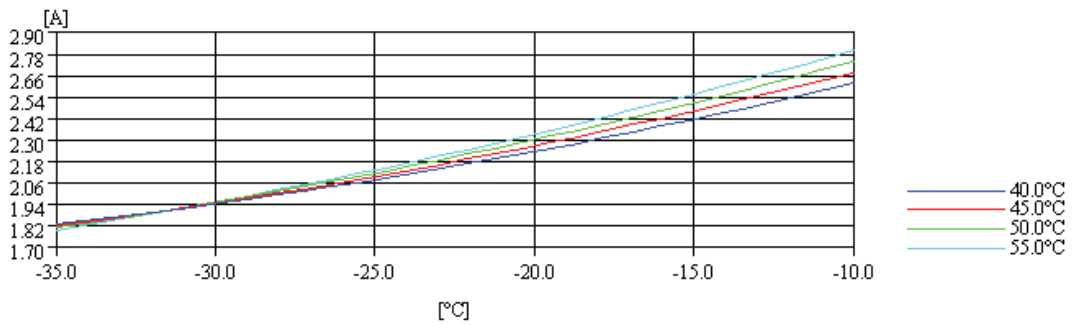

**CONSUMPTION**

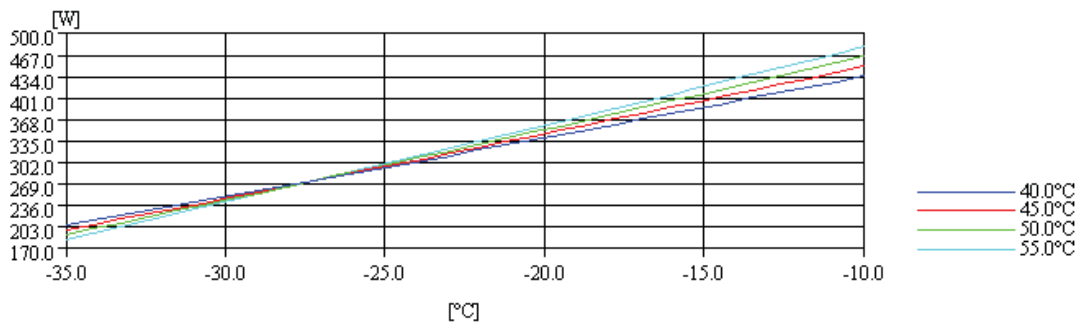

**COOLING CAPACITY**

